

SCHEMATIC

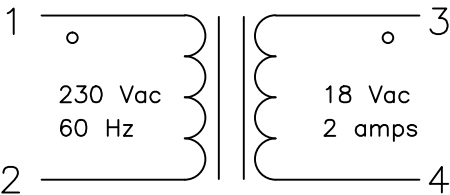

ELECTRICAL SPECIFICATIONS

DCR primary = 43.5 ohms nominal at 25 C
DCR secondary = 363 milliohms nominal at 25 C
Hypot = 2500 Vac primary to secondary

MATERIAL SPECIFICATIONS

Primary lead wire = stranded UL 1007 24 awg
Secondary lead wire = stranded UL 2007 20 awg
All materials minimum 105 C rated.
Varnish bake and dip

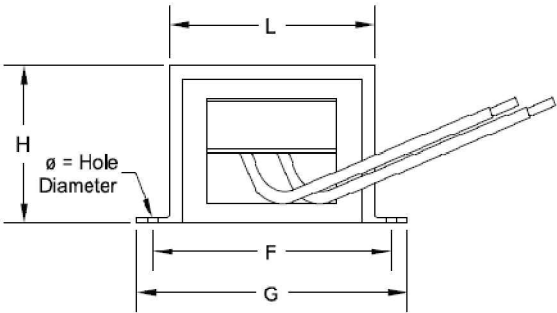
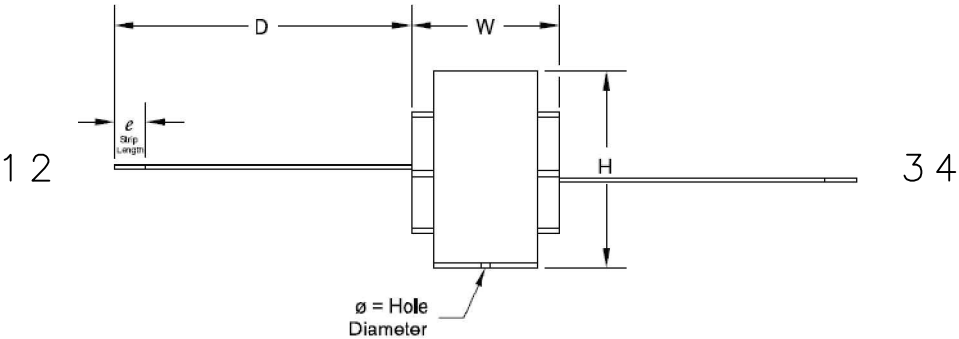

Product Code	L	W	H	F	G	ø	D	e	Lead Wire
802-9	<u>2.73</u> 69.3	<u>1.82</u> 46.2	<u>2.38</u> 60.5	<u>3.125</u> 79.4	<u>3.69</u> 93.7	<u>0.187</u> 4.7	6"	1/2	24 AWG

UNLESS OTHERWISE SPECIFIED DIMENSIONS ARE IN INCHES TOLERANCES PER ANSI Y14.5M FRAC DECIMALS ANGLES SURF. ±1/32 .X ± 0.10" ± 1 deg. .XX ± 0.05 .XXX ± 0.02" .XXX ± 0.005"	WEST COAST MAGNETICS 4848 FRONTIER WAY, STE. 100 STOCKTON, CA 95215 WWW.WCMAGNETICS.COM 800-628-1123		
	CUSTOMER WCM		DESCRIPTION 60 Hz Transformer
DRAWING NOT TO SCALE UNLESS NOTED.	PART NUMBER WCMLTR001		REV. —
	RELEASED BY WL		DATE 1/12/2015
			PAGE 1/1